

FINAL PROGRAM

The 36th Meeting of the **Scandinavian Sarcoma Group**

Helsinki



Date: October 9-11, 2013

Place: Hotel Crowne Plaza

Mannerheimintie 50 – Helsinki

00260 Finland

Hotel Front Desk +358-9-2521 0000

Hotel Fax: +358-9-2521 3999

Map of conference venue – Crowne Plaza Hotel

Meeting Room	m ²
1. Meeting Room	145
2. Meeting Room	168
3. Meeting Room	78
4. Meeting Room	61
5. Meeting Room	54
1.-5. Meeting Rooms	100
Meeting Room 10 & 11	106
12. Meeting Room	53
13. Board room	60
14. Meeting Room	93
Royal Sali	518
Winter Garden	212

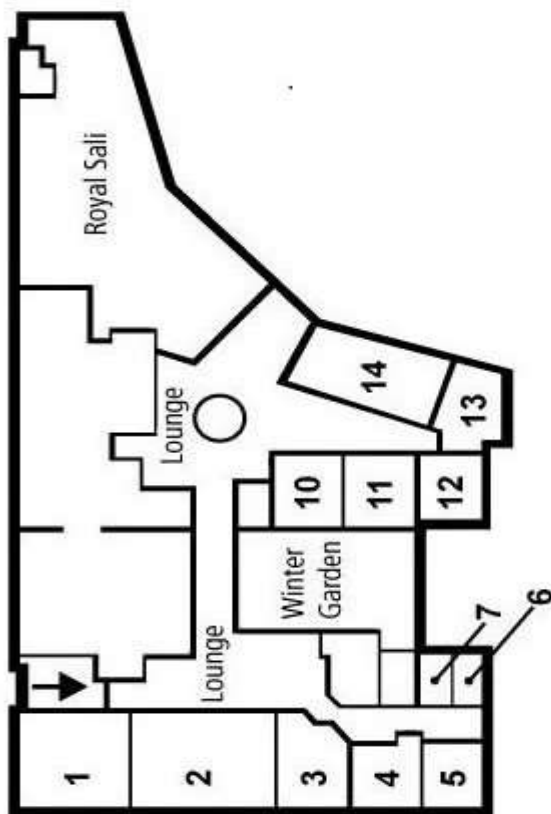

Exhibition area is placed inside and outside “Winter Garden”
 Posters will be placed in Meeting room 1&2

Preface

We are very pleased to welcome you to the Scandinavian Sarcoma Group's 36th Plenary meeting in Helsinki, October 9-11, 2013.

We are confident that this year's conference will include several speakers discussing topics of high interest to our participants. One of the core themes of the meeting will be the diagnosis and treatment challenges related to children with sarcoma, which will be covered during presentations on both Wednesday and Thursday. Additionally, there will be sessions on giant cell tumors and the latest developments in the use of biomarkers, as well as discussions on new pathological entities and treatment of sarcomas. An update on ongoing and future treatment protocols for bone- and soft tissue sarcomas will also be presented. Lastly, a joint session with nurses and physiotherapists will deal with cancer related fatigue, network focused nursing in teenagers and reconstructive surgery in soft tissue sarcoma. In addition to the keynote speakers, there will be free presentations and a poster session.

We hope that all SSG members and other participants will find the conference valuable and inspiring and take the opportunity to further progress our collaborative work.

We wish you an enjoyable and memorable stay in Helsinki.

Calle Blomqvist

Local coordinator for the meeting in Helsinki

Kirsten S. Hall, Otte Brosjø

Chairmen of the Scandinavian Sarcoma Group

Next SSG meeting:

19th Working group meeting , Malmö, February 2-4, 2014

37th Plenary meeting, Stockholm, May, 2015

Program committee members:

Calle Blomqvist, Otte Brosjø, Tom Böhling, Jacob Engellau, Mikael

Eriksson, Regina Uhre Hansen, Jukka Kanerva, Aarne Kivioja, Sakari Knuutila,

Toni Oja, Anne-Lise Salbu, Maija Tarkkanen, Erkki Tukiainen, Lotta Våde,

Eva-Mari Olofsson, Thor. A. Alvegård and Kirsten Sundby Hall.

Contents

Map of conference venue.....	2
Preface	3
SSG Plenary Meeting	
Wednesday October 9.....	6
Thursday October 10	7-9
Friday October 11	10-11
Program for SSG nurses and physiotherapists	
Wednesday October 9.....	12
Thursday October 10	13-15
Friday October 11	16-17
Social program.....	18
The Scandinavian Sarcoma Group thanks our supporters	19
Organization of the Scandinavian Sarcoma Group.....	20-22

SSG Plenary Meeting

Tuesday October 8, 2013

17.00–19.00 Board meeting
 Room: Meeting room 12

20.00 Dinner (board members only)
 Restaurant Töölönranta

SSG Plenary Meeting

Wednesday October 9, 2013

- 12.00–17.00 Registration (outside Meeting room 1, 2&3)
Exhibition Stand (Winter Garden)
Poster Exhibition (Meeting room 1&2)
- 13.00–14.00 *Lunch (Hotel Restaurant Royal Sali)*
- 14.00 Introduction and welcome
Room: Meeting room 1&2
C. Blomqvist, Helsinki, K. Sundby Hall, Oslo
- 14.15–16.45 Session I – Rhabdomyosarcoma and bone sarcomas**
Joint session with doctors, scientists, nurses and
physiotherapists
Room: Meeting room 1&2
Chairmen: *S. Smeland, Oslo, A. Kivioja, Helsinki,*
T. Alvegård, Lund
- 14.15 L1 Identification of new targets and combinations in the treatment
of rhabdomyosarcoma and Ewing’s sarcoma
L. Helman, Bethesda, USA
- 14.45 L2 a) Surgery or not in Ewing’s sarcoma of the spine, sacrum and
pelvis. A Scandinavian sarcoma group experience
O. Brosjö, Stockholm,
L2 b) Surgery or radiotherapy for Ewing’s sarcoma
Ø. Bruland, Oslo
- 15.15 L3 Reconstructive surgery in pelvic sarcomas
W. Winkelmann, Hamburg
- 15.45–16.15 *Coffee break (Winter Garden)*
- 16.15 L4 Scandinavian sarcoma group (SSG) - Bone sarcoma trials
K. Sundby Hall, S. Smeland, Oslo
- 16.45–17.15 SSG matters (members only)**

SSG Plenary Meeting

Thursday October 10, 2013

07.00–08.30 *Breakfast*

07.45–08.30 Registration (outside Meeting room 1, 2&3)

08.30–12.30 Session II – Paediatric sarcoma

Room: Meeting room 1&2

Chairmen: *U. Pihkala, Helsinki, C. Rechner, Copenhagen*

08.30 L5 Treatment of rhabdomyosarcoma (RMS) and Ewing´s sarcoma (ES)
L. Helman, Bethesda, USA

09.15 L6 Surgical treatment in paediatric bone sarcomas (including special surgical techniques for growing bones)
M. Manfrini, Bologna

09.45 L7 Radiotherapy of paediatric sarcoma
I. Kristensen, Lund

10.00 L8 Proton radiation of paediatric sarcomas
K. Nilsson, Uppsala

10.15–10.45 *Coffee break (Winter Garden)*

Chairmen: *A. Krarup-Hansen, Herlev, J. Karlén, Stockholm*

10.45 L9 Soft tissue sarcomas in adults and children; therapeutic differences and similarities
A. Ferrari, Milan, Italy

11.15 L10 A paediatric cancer registry in southern Sweden for clinical follow-up and research on late complications in long-term survivors after childhood cancer: BORISS
T. Wiebe, L. Hjorth, I. Øra, S. Garwicz, Lund

- 11.45 - 12.15** **Special session**
 Chairman: *M. Eriksson, Lund*
- 11.45 L11 Trabectedin – Standard use and novel results
J-Y. Blay, Lyon, France
- 12.15–12.30 Discussion
- 12.30–13.30* *Lunch (Hotel Restaurant Royal Sali)*
- 13.30–15.30** **Session III – Novel options in sarcomas**
 Room: Meeting room 1&2
 Chairmen: *M. Eriksson, Lund, B. Bjerkehagen, Oslo*
- 13.30 L12 Novel biomarkers in sarcoma
F. Mertens, Lund
- 14.00 L13 GIST – The break-through
H. Joensuu, Helsinki
- 14.30 L14 Novel systemic treatments in sarcomas
I. Judson, London
- 15.00 L15 Current developments in osteosarcoma
S. Bielack, Stuttgart
- 15.30–16.00* *Coffee break (Winter Garden)*
- 16.00–17.00** **Session IV – Giant cell tumor (GCT)**
 Room: Meeting room 1&2
 Chairmen: *E. Tukiainen, Helsinki, O. Zaikova, Oslo*
- 16.00 L16 Pathophysiology and biomarkers in giant cell tumor
T. Böhlring, Helsinki
- 16.10 L17 Giant cell tumors – Surgery
A. Kivioja, Helsinki
- 16.30 L18 Radiotherapy in giant cell tumor of bone
C. Blomqvist, Helsinki
- 16.45 L19 Safety and efficacy of Denosumab for giant cell tumor of bone
J. Engellau, Lund

17.00-18.00**Free presentations**

Chairmen: *F. Vult von Steyern, Lund, P. Lindholm, Turku*

- 17.00 L20 Multinational collaboration: A long-term surveillance program for osteosarcoma and potential exposure to Teriparatide
A. W. Gilsenan, RTI Health Solutions, Research Triangle Park, NC, United States
- 17.10 L21 Improvements in the diagnostic process of sarcomas. Effects of a national implemented cancer pathway
J. Keller, Aarhus, Denmark
- 17.20 L22 Bone sarcomas in the Scandinavian sarcoma group central register – 25-years´experience
O. Zaikova, Oslo
- 17.30 L23 Postirradiation sarcoma following treatment of breast cancer: a nationwide, population-based analysis
S. Salminen, Helsinki
- 17.40 L24 Patterns of local recurrence and dose fractionation of adjuvant radiotherapy in 462 patients with soft tissue sarcoma of extremity and trunk wall. A Scandinavian sarcoma group study
N.L. Jebsen, Bergen
- 17.50 L25 Radiation associated angiosarcoma after breast cancer: improved survival by excision of all irradiated soft tissue of the thoracic wall?
E. Styring, Lund

SSG Plenary Meeting

Friday October 11, 2013

07.00–08.30 *Breakfast*

07.45–08.30 Registration (outside Meeting room 1, 2&3)

**08.30–15.10 Session V – Soft tissue sarcoma (STS)
Joint session with doctors, scientists, nurses and
physiotherapists**

Room: Meeting room 1&2

Chairmen: *C. Blomqvist, Helsinki, L. Våde, Oslo*

08.30 L26 New soft tissue tumors entities
M. Miettinen, NCI, Bethesda, Maryland, USA

09.30–10.00 *Coffee break (Winter Garden)*

10.00 L27 Cancer related fatigue – what do we know and how do we help
our patients?
R. Gjessing Borgheim, Oslo

10.30 L28 Network focused care and young people with cancer
P. Riis Olsen, Aarhus

11.00 L29 Exercise oncology – A strategy for improving cancer patients
well-being during and after treatment
K. Bloomquist, Copenhagen

11.30 L30 Reconstructive surgery in soft tissue sarcoma
E. Tukiainen, Helsinki

12.00–13.00 *Lunch (Hotel Restaurant Royal Sali)*

13.00 L31 Scandinavian sarcoma group (SSG) - Soft tissue sarcoma trials
M. Eriksson, Lund

13.30-15.00

Session VI - Poster presentations

Chairmen: *C. Blomqvist, Helsinki, P. Bergh, Gothenburg,
B. Brodin, Stockholm*

15.00-15.10

Closing remarks

C. Blomqvist, Helsinki, K. Sundby Hall, Oslo

Coffee (Winter Garden)

Program for SSG nurses and physiotherapists

Wednesday October 9, 2013

- 11.30–12.30 Board meeting (Meeting room 12)
- 12.00–17.00 Registration (outside Meeting room 1, 2&3)
Exhibition Stand (Winter Garden)
Poster Exhibition (Meeting room 1&2)
- 13.00–14.00 *Lunch (Hotel Restaurant Royal Sali)*
- 14.00 Introduction and welcome
Room: Meeting room 1&2
C. Blomqvist, Helsinki, K. Sundby Hall, Oslo
- 14.15–16.45 Session I – Rhabdomyosarcoma and Bone sarcomas
Joint session with doctors, scientists, nurses and
physiotherapists**
Room: Meeting room 1&2
Chairmen: *S. Smeland, Oslo, A. Kivioja, Helsinki,
T. Alvegård, Lund*
- 14.15 L1 Identification of new targets and combinations in the treatment
of rhabdomyosarcoma and Ewing´s sarcoma
L. Helman, Bethesda, USA
- 14.45 L2 a) Surgery or not in Ewing´s sarcoma of the spine, sacrum and
pelvis. A Scandinavian sarcoma group experience
O. Brosjö, Stockholm,
L2 b) Surgery or radiotherapy for Ewing´s sarcoma
Ø. Bruland, Oslo
- 15.15 L3 Reconstructive surgery in pelvic sarcomas
W. Winkelmann, Hamburg
- 15.45–16.15 *Coffee break (Winter Garden)*
- 16.15 L4 Scandinavian sarcoma group (SSG) - Bone sarcoma trials
K. Sundby Hall, S. Smeland, Oslo
- 16.45–17.15 SSG matters (members only)**

Program for SSG nurses and physiotherapists

Thursday October 10, 2013

- 07.00–08.30 *Breakfast*
- 07.45–08.30 Registration (outside Meeting room 1, 2&3)
- 08.30–18.00 Nurses and physiotherapists session**
Room: Meeting room 3
- 08.30–08.40 Welcome!
- 08.40-10.20 Session I – Children with sarcoma**
Chairmen: *S. Granlien, Oslo, A. Pettersson, Umeå*
- 08.40 L32 Rehabilitation including social, physical activity and education
in children and teenagers with cancer (RESPECT)
H. Baekgaard Larsen, Copenhagen
- 09.00 L33 Children with sarcomas - Nursing challenges:
How can we as nurses assist families to optimal cope with
children who has sarcoma
P. Kettler, Oslo
- 09.20 L34 Low level laser therapy in the treatment of oral mucositis in a
paediatric haemato – oncology and stem cell transplantation unit
V. Van de Velde, Ghent
- 09.50 L35 Organizing patient interests in the Nordic countries – patients
helping patients
F. Dyne Homb, Oslo
- 10.20–10.45 *Coffee break (Winter Garden)*
- 10.45-12.30 Session II - Prostheses**
Chairmen: *A-L Salbu, Bergen, R. Uhre Hansen, Herlev*
- 10.45 L36 Prostheses, - what's new?
G. Prestbakmo, Oslo

- 11.00 L37 Special prostheses to sarcoma patients
B. Hedegaard, Aarhus
- 11.20 L38 When to use a tumor prosthesis
M. Nottrott, Münster
- 11.40 L39 Rehabilitation after amputation in upper extremity
E. Rasmussen, Copenhagen
- 12.00 L40 Working as a sarcoma nurse in plastic surgery ward
K. Olenius, Helsinki
- 12.30–13.30 Lunch (Hotel Restaurant Royal Sali)*
- 13.30-15.30 Session III – Coping during and after treatment**
Chairmen: *A. Lekven, Stavern, C. Persson, Lund*
- 13.30 L41 Nutrifriend 1100 in cancer – “Protector of good and killer of evil?”
T.K. Nystrøm, Oslo
- 13.50 L42 Rehabilitation of sarcoma patients
H. Gustafsson, Helsinki
- 14.10 L43 Activity week – challenge yourself
K. Heiberg Rasch, M. Evertsen, Stavern
- 14.45 L44 Patient story
- 15.30–16.00 Coffee break (Winter Garden)*
- 16.00–17.00 Annual meeting**

17.00

Free presentations

Room: Meeting room 1&2

Chairmen: *F. Vult von Steyern, Lund, P. Lindholm, Turku*

- 17.00 L20 Multinational collaboration: A long-term surveillance program for osteosarcoma and potential exposure to Teriparatide
A. W. Gilsenan, RTI Health Solutions, Research Triangle Park, NC, United States
- 17.10 L21 Improvements in the diagnostic process of sarcomas. Effects of a national implemented cancer pathway
J. Keller, Aarhus, Denmark
- 17.20 L22 Bone sarcomas in the Scandinavian sarcoma group central register – 25-years´experience
O. Zaikova, Oslo
- 17.30 L23 Postirradiation sarcoma following treatment of breast cancer: a nationwide, population-based analysis
S. Salminen, Helsinki
- 17.40 L24 Patterns of local recurrence and dose fractionation of adjuvant radiotherapy in 462 patients with soft tissue sarcoma of extremity and trunk wall. A Scandinavian sarcoma group study
N.L. Jebsen, Bergen
- 17.50 L25 Radiation-associated angiosarcoma after breast cancer: improved survival by excision of all irradiated soft tissue of the thoracic wall?
E. Styring, Lund

Program for SSG nurses and physiotherapists

Friday October 11, 2013

07.00–08.30 *Breakfast*

07.45–08.30 Registration (outside Meeting room 1, 2&3)

**08.30–15.10 Session V – Soft tissue sarcoma (STS)
Joint session with doctors, scientists, nurses and
physiotherapists**

Room: Meeting room 1&2

Chairmen: *C. Blomqvist, Helsinki, L. Våde, Oslo*

08.30 L26 New soft tissue tumors entities
M. Miettinen, NCI, Bethesda, Maryland, USA

09.30–10.00 *Coffee break (Winter Garden)*

10.00 L27 Cancer related fatigue – what do we know and how do we help
our patients?
R. Gjessing Borgheim, Oslo

10.30 L28 Network focused care and young people with cancer
P. Riis Olsen, Aarhus

11.00 L29 Exercise oncology – A strategy for improving cancer patients
well-being during and after treatment
K. Bloomquist, Copenhagen

11.30 L30 Reconstructive surgery in soft tissue sarcoma
E. Tukiainen, Helsinki

12.00–13.00 *Lunch (Hotel Restaurant Royal Sali)*

13.00 L31 Scandinavian sarcoma a group (SSG) - Soft tissue sarcoma trials
M. Eriksson, Lund

13.30-15.00

Session VI - Poster presentations

Chairmen: *C. Blomqvist, Helsinki, P. Bergh, Gothenburg,
B. Brodin, Stockholm*

15.00-15.10

Closing remarks

C. Blomqvist, Helsinki, K. Sundby Hall, Oslo

Coffee (Winter Garden)

SOCIAL PROGRAM

Wednesday October 9, 2013

18.00 Reception at Helsinki Music Hall

19.00 – 21.20 Concert, Helsinki Music Hall

Thursday October 10, 2013

19.30 Gala Dinner at restaurant Royal Sali, Hotel Crowne Plaza

Participation in the social program is not included in the registration fee. Price 600 SEK. To be booked in advance on the registration form



Helsinki Music Hall

Skandinaviska Sarkomgruppen tackar

*Stiftelsen Sat Sapienti, Novartis Norden,
GlaxoSmithKline AB,
Swedish Orphan Biovitrum, Amgen AB,
Takeda Pharmaceuticals, Merck/Schering-Plough,
Treestep Oy, Stanmore Implants
Swedish Cancer Foundation*

som stött oss ekonomiskt i genomförandet av
gruppens 36:e möte i Helsingfors 2013!

Exhibitions

Stand

<i>Novartis</i>	<i>1</i>
<i>GlaxoSmithKline AB</i>	<i>2</i>
<i>Swedish Orphan Biovitrum</i>	<i>3</i>
<i>Amgen AB</i>	<i>4</i>
<i>Takeda Pharmaceuticals</i>	<i>5</i>
<i>Merck/Schering-Plough</i>	<i>6</i>
<i>Treestep Oy</i>	<i>7</i>
<i>Stanmore Implants</i>	<i>8</i>

Organization of the Scandinavian Sarcoma Group (SSG)

Chairmen: K. Sundby Hall, Oslo, O. Brosjö, Stockholm
Vice Chairmen: P. Lindholm, Turku, Anders Krarup-Hansen, Herlev
Honorary: T.A. Alvegård (Honorary chairman),
N.O. Berg (†2008), T.R. Möller, M. Åkerman,
A. Rydholm Lund
B. Gunterberg, Gothenburg
U. Nilsson (†2008), Stockholm
Ø. Solheim, K. Talle, A.E. Stenwig, G. Saeter, G. Follerås, Oslo
I. Elomaa, Helsinki
Secretary: M. Eriksson, Lund
Vice Secretary: A. Rydholm, Lund
Treasurer: T.A. Alvegård, Lund
National
representative: H. Jonsson Jr, Iceland
Secretariat: Eva-Mari Olofsson
Regional Cancer Center (RCC)
Scheelevägen 8, 223 81 Lund
Tel: +46-46-17 75 55
Fax: +46-46-18 81 43
E-mail: ssg@med.lu.se
www.ssg-org.net

Clinical trials

M. Eriksson, M.D Prof., Lund
J. Ceberg, Coordinator/Monitor, Lund
M. Rejmyr Davis, Data management, Lund

Program committee

M. Eriksson, Lund
A. Rydholm, Lund
O. Brosjö, Stockholm
K. Sundby Hall, Oslo

Data management

M. Nilbert, Lund
E. Johansson, Lund
M. Rejmyr Davis, Lund

Statistician

L. Werner Hartman, Lund

SSG Board

Chairmen: K. Sundby Hall, Oslo, O. Brosjö, Stockholm

Members: T. Alvegård, Lund, H.C.F. Bauer, Stockholm, B. Bjerkehagen, Oslo, J. Engellau, Lund, O. Brosjö, Stockholm, M. Eriksson, Lund, T. Hølmekbakk, Oslo, N. Jebsen, Bergen, H. Jonsson Jr, Reykjavik, A. Krarup-Hansen, P. Lindholm, Åbo, F. Mertens, Lund, E-M. Olofsson, Lund, A. Rydholm, Lund, M. Skorpil, Stockholm, F. Vult von Steyern, Lund, L. Våde, Oslo, J. Åhlén, Stockholm

SUBCOMMITTEES

CENTRAL REGISTER

Chairman: H. C. F. Bauer, Stockholm

Local coordinators

Denmark

G. Lausten, Copenhagen, P. Holmberg Jørgensen, Århus

Iceland

H. Jonsson Jr, Reykjavik

Finland

C. Blomqvist, Helsinki, M. Laitinen, Tampere, P. Lindholm, Åbo

Norway

C. Trovik, Bergen, K. Sundby Hall/O. Zaikova, Oslo, E. Smeland/V. Isaksen, Tromsø, H. Knobel, Trondheim

Sweden

M. Erlanson/R. Löfvenberg/I. Johansson, Umeå, H.C.F. Bauer/J. Åhlén/A. Hesla, Stockholm, F. Vult von Steyern/E. Styring, Lund, A. Kalén, Linköping, S. Eriksson/P. Berg, Gothenburg

IMAGING

Chairman: M. Skorpil, Stockholm

MORPHOLOGY/TUMOR BIOLOGY

Chairmen: B. Bjerkehagen, Oslo, F. Mertens, Lund

ORTHOPAEDIC SURGERY

Chairman: F. Vult von Steyern, Lund

VISCERAL AND RETROPERITONEAL SARCOMA

Chairmen: J. Åhlén, Stockholm, T. Hølmekbakk, Oslo

MEDICAL ONCOLOGY

Chairmen: K. Sundby Hall, Oslo, M. Eriksson, Lund

RADIOTHERAPY

Chairmen: J. Engellau, Lund, N. Jebsen, Bergen

NURSES AND PHYSIOTHERAPISTS

Chairmen: L. Våde, S. Granlien, Oslo

Secretary: I. M. Johansson, Umeå

Treasurer: A.L. Salbu, Bergen

Webmaster: M. L. Johansen, Oslo

Members: A. Lekven, Stavern, L. Høiland, Bergen, E. Muszka, Stockholm,
S. Møller and B. Hedegård, Århus